



Richmond Birdwing Butterfly Project

Sunshine Coast Airport passengers and visitors alike will be welcomed to the terminal by a Richmond Birdwing Butterfly habitat that will be established as part of the redevelopment.

The Richmond Birdwing Butterfly, one of Australia's most impressive and beautiful native butterflies, is under threat of extinction as a result of habitat destruction and loss of its one larval food plant.

In the hope of securing the butterflies' future on the Sunshine Coast the Airport is working with community groups to establish and provide a safe habitat in which the Richmond Birdwing Butterfly can live and breed.

Sunshine Coast Regional Council

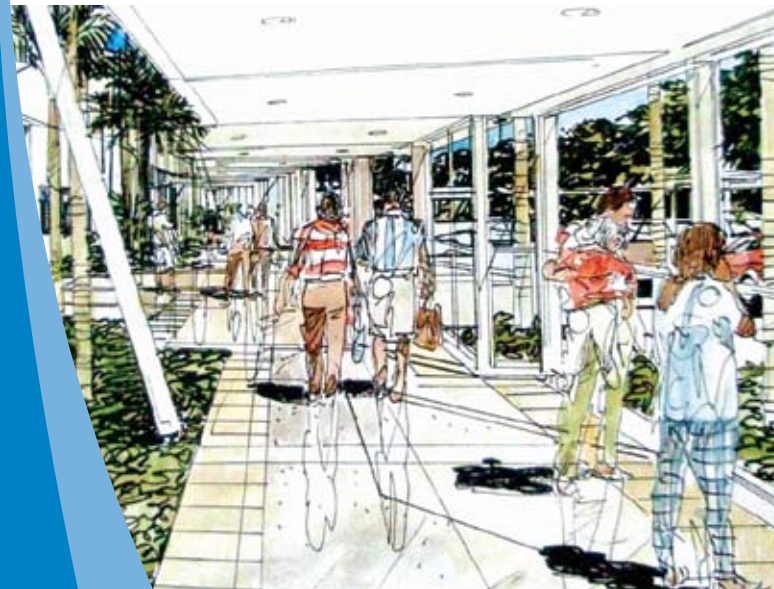

Sunshine Coast Airport welcomes new operators Spotless and AWPL Property Solutions who will establish a number of new outlets including:

Sumo Salad

- Gourmet salads and a range of healthy alternatives; wraps, rolls, toasties, fresh juices, yoghurt and more.

Velluto Espresso Bar

- Velluto Cafe will offer hearty breakfasts, sandwiches, focaccias and coffee - with beans provided exclusively by an award winning Queensland coffee roaster.

The Glass House Bar

- Enjoy the view, a light pub style meal, ale or glass of wine while waiting to board your flight

Rip Curl

- The ultimate surfing company - built by surfers for surfers. Guys and girls swimwear and surfwear, watches, footwear, bags, eyewear and a huge range of accessories.

News Travels

- All the newspapers, magazines, latest release books, travel guides and snacks for your trip as well as gifts and souvenirs from the Sunshine Coast for those last minute shoppers.

Locked Bag 72, SCMC Qld 4560
p (61 7) 5453 1500 f (61 7) 5453 1511
e airport@sunshinecoast.qld.gov.au

Sunshine Coast Airport Terminal Redevelopment



www.sunshinecoastairport.com.au

Stage One of Sunshine Coast Airport's Master Plan is underway with the Sunshine Coast Regional Council allocating \$3.6 million to the redevelopment of the existing airport terminal and departure lounge.

The planned refurbishment will significantly enhance the travelling experience for all of the airport's commuters, visitors and staff, and ultimately deliver unprecedented economic benefits to the Sunshine Coast.

The new development, designed to reflect the natural light and feel of the Sunshine Coast region, will incorporate a unique rainforest walk as well as the creation of a Richmond Birdwing Butterfly habitat.

By providing an enhanced travelling experience for visitors the multi-million dollar refurbishment will support continued growth of the tourism industry on the Sunshine Coast.

Due to the complexity of works there may be some inconvenience to passengers, however, all efforts will be taken to minimise impact. Work is expected to be completed in late 2009.

Key Highlights

- The new design of the terminal will significantly reduce the amount of time spent in queues at the security screening point.
- Both passengers and visitors to the airport will be able to enter the more spacious departure lounge where all shops will be located and additional amenities will be provided.
- A broader retail, food and beverage experience will be available including a larger store for the Sunshine Coast's unique Jewellery Lounge. **The Jewellery Lounge**, a long-term tenant of the airport, offers a first class range of jewellery, watches and designer handbags.

The Sunshine Coast Airport Floor Plan

